

# JACKSON COUNTY GEODETIC CONTROL

**STATION: WB002**

**DESCRIPTION:**

**BRASS DISK SET IN CONCRETE RECESSED APPROXIMATELY 0.3 FEET BELOW GROUND. POINT IS LOCATED IN THE RIGHT OF WAY ON THE WEST SIDE OF BUCKEYE BLUFF, 0.2 MILE SOUTH OF CHAMBERS ROAD AND APPROXIMATELY 3 MILES NORTH OF THE CITY OF COMMERCE. POINT IS 4.0 FEET WEST OF THE EDGE OF PAVEMENT, 70 FEET SOUTH OF A STREETLIGHT, 62.5 FEET NORTH OF A TELEPHONE BOX, AND 26.5 FEET SOUTHWEST OF THE MAILBOX FOR HOUSE #143 BUCKEYE BLUFF. MONUMENT IS LOCATED IN BANKS COUNTY.**

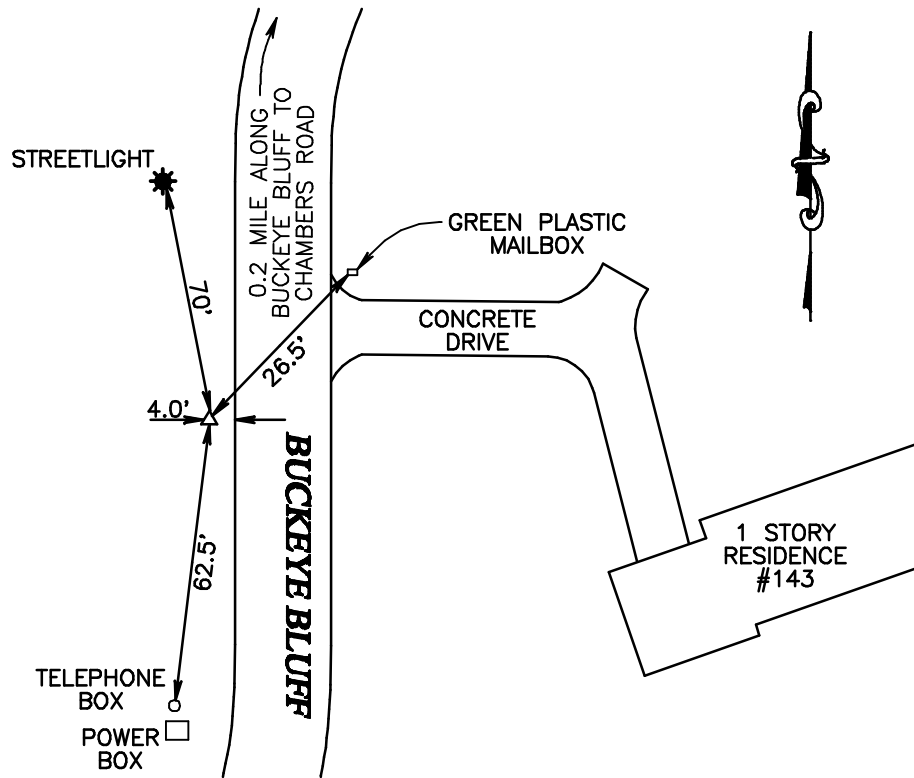

**HORIZONTAL CONTROL**

GEORGIA STATE PLANE COORDINATE SYSTEM  
WEST ZONE, NAD 83, NSRS 2007

NORTHING (U.S. SURVEY FEET): 1546125.61  
EASTING (U.S. SURVEY FEET): 2517083.90  
SCALE FACTOR: 0.99992505

LATITUDE: 34° 14' 53.0897" N  
LONGITUDE: 83° 26' 13.1510" W

DATE ESTABLISHED: APRIL 15, 2008

DATE OF LAST RECOVERY:

**VERTICAL CONTROL**

NAVD 88/ GEOID 03  
ORTHOMETRIC ELEVATION: 737.72 FEET  
ELLIPSOID HEIGHT: 639.92 FEET  
GEOID SEPARATION: -97.80 FEET

PREPARED BY  
**WOOD BROTHERS  
& SCOTT, INC.**  
Land Surveying  
Civil Engineering & Land Planning

345 STOREY LANE  
JEFFERSON, GA. 30549  
(706) 387-0075

