

# JACKSON COUNTY GEODETIC CONTROL

**STATION: WB011**

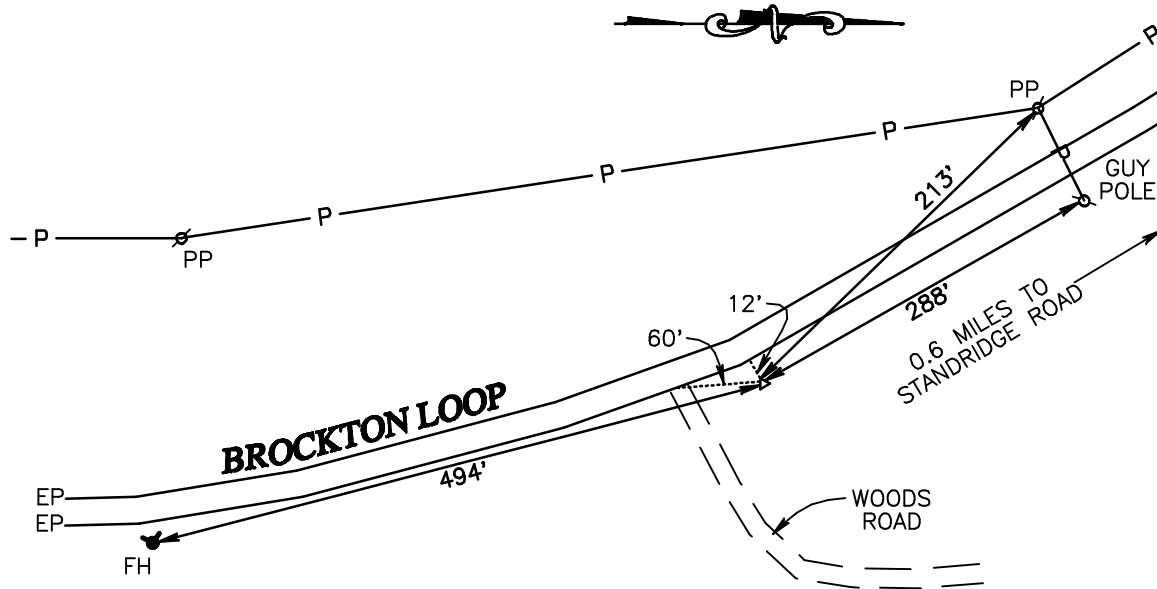

**DESCRIPTION:**

**BRASS DISK SET IN CONCRETE RECESSED APPROXIMATELY 0.6 FEET BELOW GROUND. POINT IS LOCATED IN THE RIGHT OF WAY ON THE EAST SIDE OF BROCKTON LOOP 0.6 MILES SOUTH OF ITS INTERSECTION WITH STANDRIDGE ROAD AND APPROXIMATELY 6 MILES EAST OF THE CITY OF JEFFERSON. POINT IS 12 FEET EAST OF THE EDGE OF PAVEMENT, 213 FEET SOUTHEAST OF A POWER POLE, 288 FEET SOUTH OF A GUY POLE, 60 FEET NORTH OF A WOODS ROAD AND 494 FEET NORTH OF A FIRE HYDRANT.**

**HORIZONTAL CONTROL**

GEORGIA STATE PLANE COORDINATE SYSTEM  
WEST ZONE, NAD 83, NSRS 2007

NORTHING (U.S. SURVEY FEET): 1490910.02  
EASTING (U.S. SURVEY FEET): 2506258.51  
SCALE FACTOR: 0.99992013

LATITUDE: 34° 05' 47.6277" N  
LONGITUDE: 83° 28' 26.5729" W

DATE ESTABLISHED: APRIL 15, 2008

DATE OF LAST RECOVERY:

**VERTICAL CONTROL**

NAVD 88/ GEOID 03  
ORTHOMETRIC ELEVATION: 728.01 FEET  
ELLIPSOID HEIGHT: 631.27 FEET  
GEOID SEPARATION: -96.74 FEET

PREPARED BY  
**WOOD BROTHERS  
& SCOTT, INC.**  
Land Surveying  
Civil Engineering & Land Planning

345 STOREY LANE  
JEFFERSON, GA. 30549  
(706) 387-0075

